

Chain GLS SERIES

Innovative magnet end cap, easy intallation without screws;

Multi-corner connectors are available: 180 ° straight, L-type, T-type, X-type;

Built-in three-in-one dimming driver;

Various of customized services: customized colors, size, material and so on.



GLS 3535

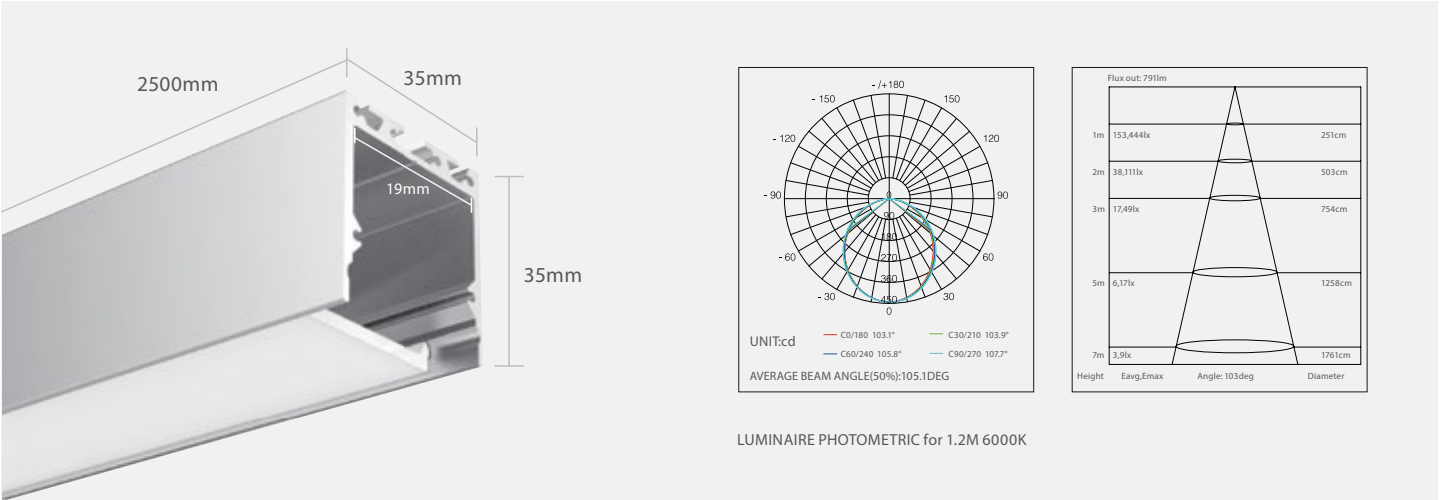

Standard



GLS3535-PRM



GLS3535-ECx8



GLS3535-SMx8

Optional



GLS3535-PY



GD8252



GCN1001/CN1003



Chain GLS Series Installation

Pendant Diagram



Step1: Main body installation: profile + driver + LED + cover + end cap

Step2: Installation of canopy

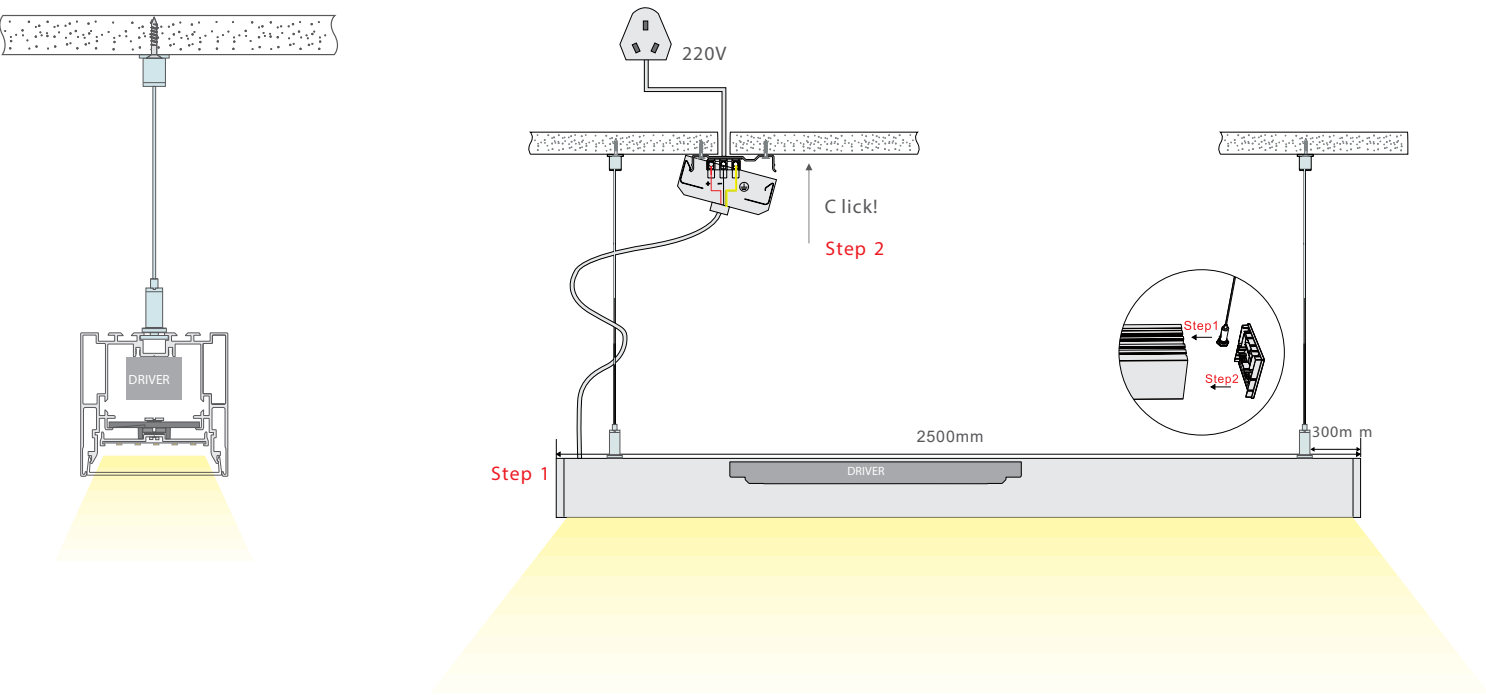

Recessed Diagram



Step1: Installation of main profile + driver + end cap

Step2: Embedded installation

Step3: Install light source + cover

Step4: Paint

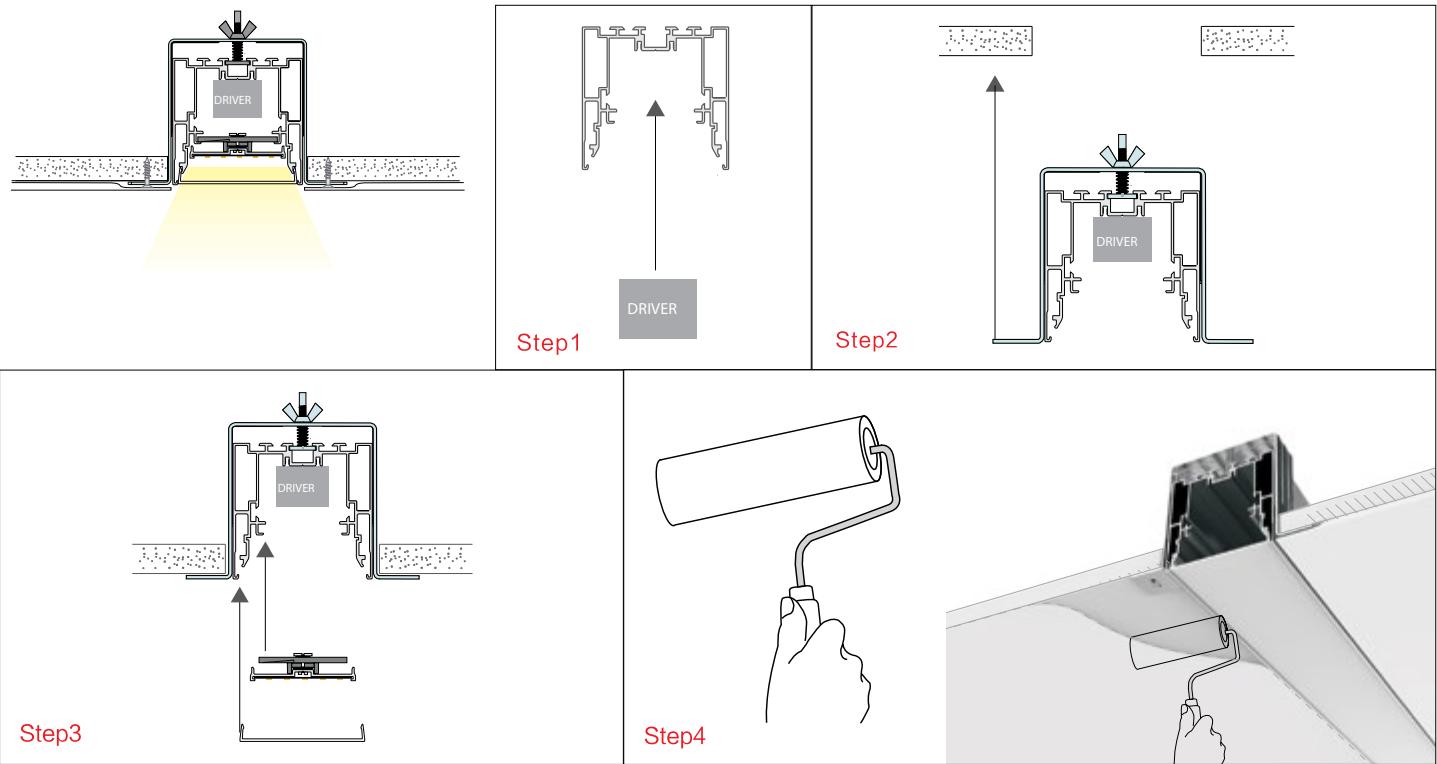

Surface Mounted / Wall Mounted Diagram



- Step1: Profile fixed: profile + driver + end cap
- Step2: Install LED + cover

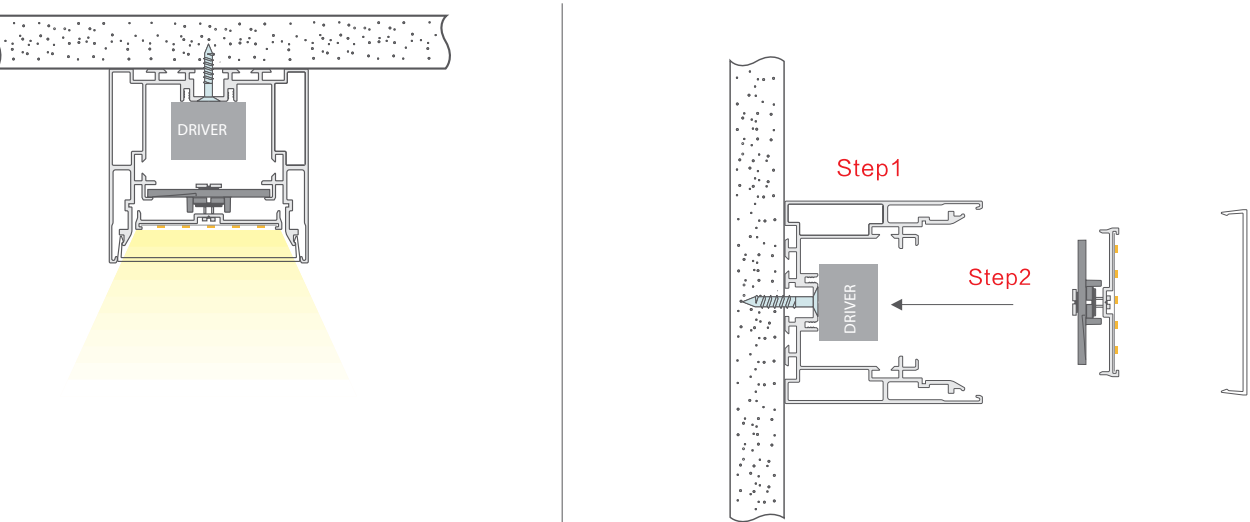

Wall Mounted Diagram



- Step1: Body installation;Profile + driver + LED + end cap + cover
- Step2: Fixed roof/wall hanging clamp
- Step3: Install profile body

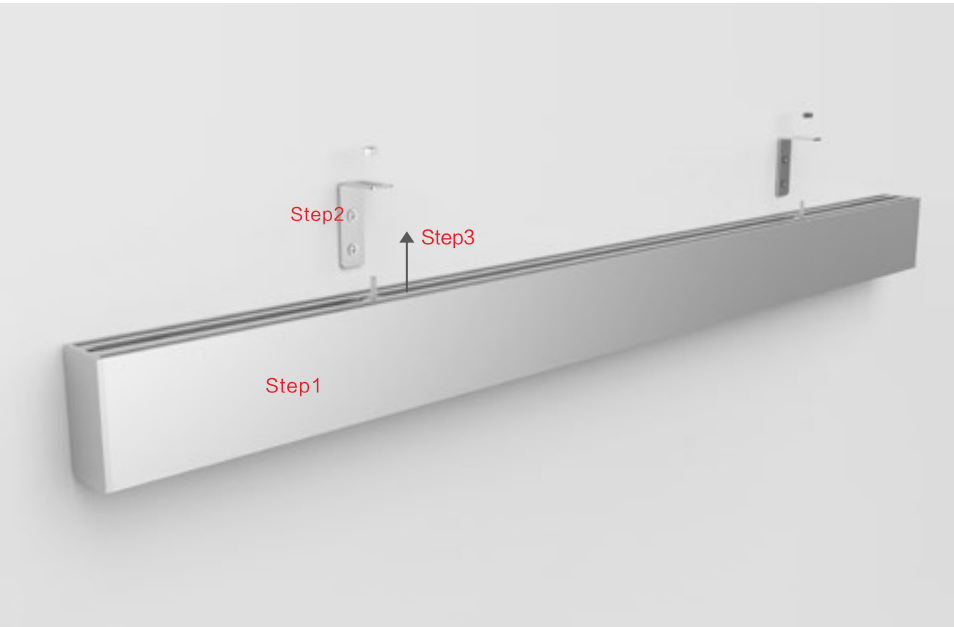
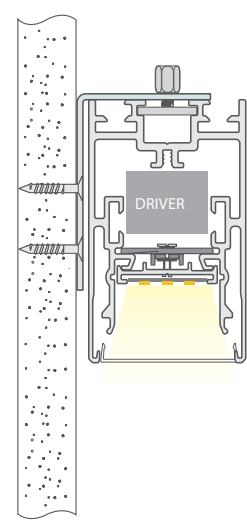

Chain Series Accessories Installation

End Cap Component Installation Diagram

- Step1: install the end cap
- Step2: install the cover
- Step3: plug a small sub-mounting

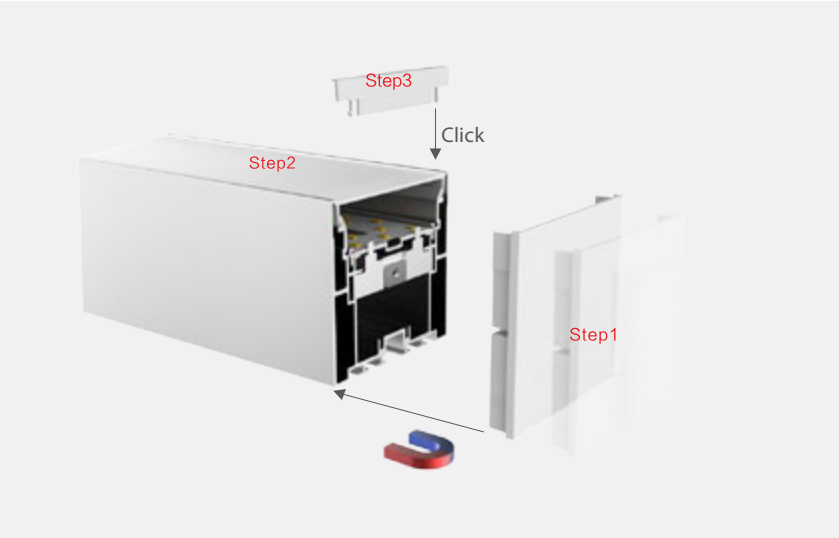
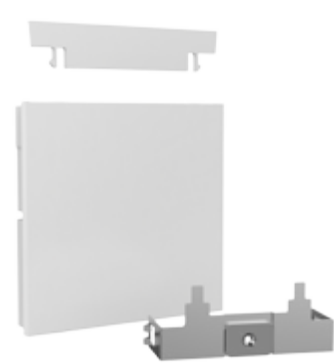

Buckle Diagram

- Step1: Stick the strip on the carrier
- Step2: Rotate 90 ° clamping

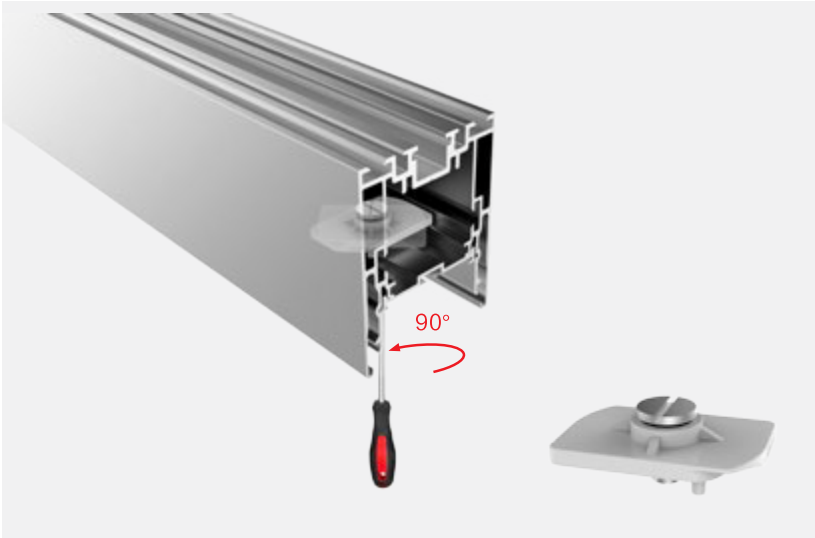
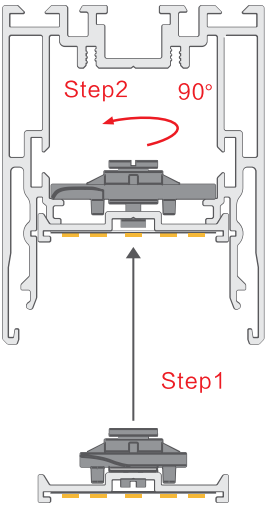

Chain Series LED Linear Light



Home Lighting

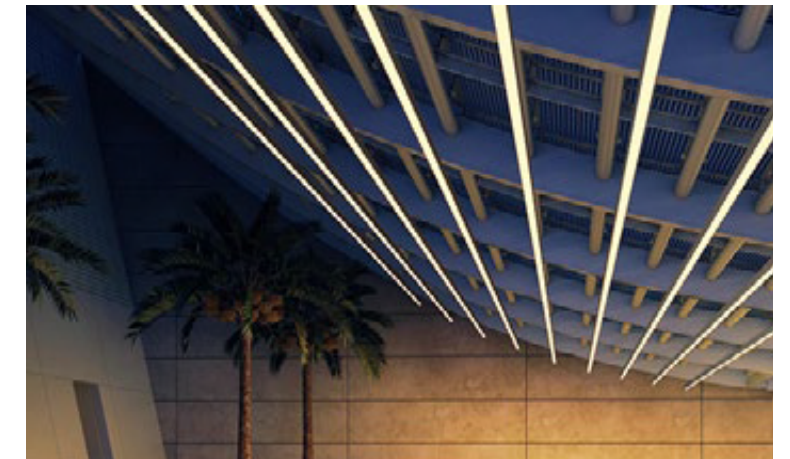

Commercial Lighting



Office Lighting



Industrial Lighting

